

TYPE MCX RF coaxial Connector is a Kind of miniature Connectors with snap-on coupling. Characteristic impedance has two types: 50Ω and 75Ω. The characteristic of connectors is in small volume, light weight, concise structure, easy to use. They are widely used in the Global position system, Digital personal computer network, all kinds of radio instruments, small-sized electronic equipments and WLAN system.

### INTERFACE MATING DIMENSIONS

Pin connector

Socket connector

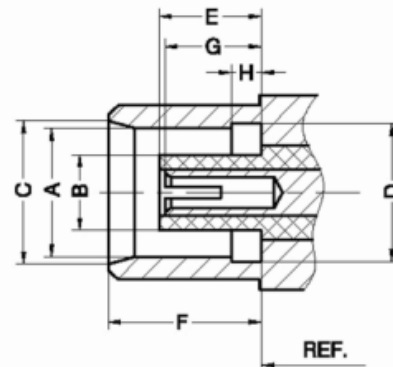
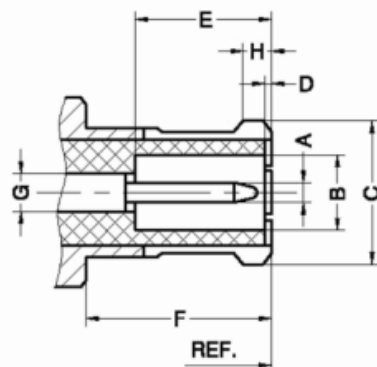

Pin connector		
Code	Millimeters	
	Min.	Max.
A	0.48	0.53
B	2.00	2.07
C	3.72	3.80
D	0.00	0.30
E	2.80	3.20
F	4.16	-
G	0.95 nom.	
H	0.70	0.75

Socket connector		
Code	Millimeters	
	Min.	Max.
A	3.42	3.48
B	1.80	1.98
C	3.80	-
D	3.61	3.76
E	2.61	2.79
F	4.00	4.12
G	2.31	2.79
H	0.75	0.85

MAJOR TECHNICAL CHARACTERISTICS

Temperature Range	-55~+155 (PE Cable -40~+85 )	
Impedance	50 , 75	
Frequency Range	DC~6GHz	
Working Voltage	250V(50 ) 170V(75 ) at sea level	
Withstanding Voltage	750V(50 ) 250V(75 ) at sea level	
Contact Resistance		
Center Contact	5m	
Outer Contact	2.5m	
Insulation Resistance	1000M	
Center conductor retention force	0.28N	
Insertion Loss	0.18dB/1GHz	
Engagement force	20N	
Disengagement force	8N	
Voltage Standing Wave Ratio		
Straight	1.20/1GHz	
Right angle	1.45/1GHz	
Durability(mating)	500 次 ( cycles )	

MATERIAL & PLATING

body	brass	gold plated
pin contact	beryllium-copper	gold plated
socket contact	beryllium-copper	gold plated
resilient contact	beryllium-copper	gold plated
insulator	PTEE	
crimp ferrule	copper alloy	nickel or gold plated
o-ring sealing	silicone rubber	

APPLICABLE STANDARD

CECC 22220  
IEC-61169-36